

5 Beryl Pl Street Lot 122 DPS 20544 Section Block

ROTORUA DISTRICT COUNCIL

Install wetback heater



REG

Owner: G. Boyle
Plumber: L. Cannon
Drainlayer:

Valuation No.: 655/959/3
Permit No.: 5925
Appn. No.: 3093
Date: 11/6/82

INSPECTIONS

Date

1-7-82

plumby resp. installed

Application No. 3093**ROTORUA DISTRICT COUNCIL**Valuation No. 655/939/13**APPLICATION FOR PERMIT TO CARRY OUT SANITARY PLUMBING AND DRAINAGE WORK**

I, the undersigned, hereby apply for permission to have the work described herein, and set out on the plans attached hereto, carried out in accordance with the provisions of the Drainage and Plumbing Regulations 1978 and Amendments at premises situated at:

Address 5 BERRY PLACE**Legal Description:**Lot No. 122 Deposited Plan No. 20544

Section No. _____ Block No. _____

Description of Work: WET BACK TO KLOVDIKE

Name and address of person for whom work is to be carried out:

G. J. BOYLEName and address of Craftsman Plumber: LESLEY CANNON.

Name and address of Registered Drainlayer: _____

	Value	Fees
Plumbing	\$:	\$ 12 :00
Drainage	\$:	\$:
TOTAL FEES		\$ 12 :00

Signature: AsBape.Date: 3.6.82.**FOR OFFICE USE ONLY**Receipt Number 10430Fee Paid \$12 —Date Paid 11.6.82.Issue Approved [Signature]Date Approved 4/6/82Permit No. 5925

See reverse for Fees and Notes

FOR OFFICE USE ONLY

FEES PAYABLE ON THE ISSUE OF ANY PLUMBING OR DRAINAGE PERMIT

according to the Estimated Value of Work

Value of work (excluding value of fittings)		
Value of Work		Permit Fee
Up to \$50		\$15
\$51 - \$100		\$20
\$101 - \$200		\$32
\$201 - \$300		\$38
\$301 - \$400		\$44
\$401 - \$500		\$50
\$501 - \$600		\$56
\$601 - \$700		\$62
\$701 - \$800		\$68
\$801 - \$900		\$75
\$901 - \$1000		\$80

\$1001 and over, \$7 extra for every \$200 or part thereof in excess of \$1000

IMPORTANT

INSPECTION AND TESTING REQUIREMENTS

DRAINAGE WORK: Drainlayers are required to notify the Plumbing and Drainage Inspector when all work is completed. This includes effluent disposal systems for septic tanks. All drains will be tested with a 1.5 m head of water. To implement this test it will be necessary for persons undertaking drainage work to have sufficient drain plugs to fill all sections of the drain prior to the Plumbing and Drainage Inspector arriving on the job, also to have available a stand pipe to apply the 1.5 m head pressure.

This form of testing is essential to exclude the possibility of ground water infiltration with its attendant increase in pumping charges and overloading of the sewers and treatment plant.

PLUMBING WORK: Plumbers are required to notify the Plumbing and Drainage Inspector when work is ready for inspection as follows:

- (a) When the building has been initially piped out and wastes are installed (before wall linings are fixed and floors laid).
- (b) When work is complete.

Plans of Drainage and Plumbing Work

In the case of single houses a preliminary drainage plan will not be required. In all other cases, however, plans of the preliminary proposal are to be submitted at the time of application for a permit. In all instances, however, an "as laid" plan must be available on site as a prerequisite to a test of the work.

In commercial buildings full plans and elevations of plumbing stacks must be provided at the time of application for a permit.

Plans MUST show dimensions and distances from section boundaries in metric units

Rotorua District Council

DRAINAGE PLAN

NEW SEWERAGE DRAINS — RED
STORMWATER — DOTTED BLACK
OLD DRAINS — FULL BLACK

~~646/118~~
655/950/3

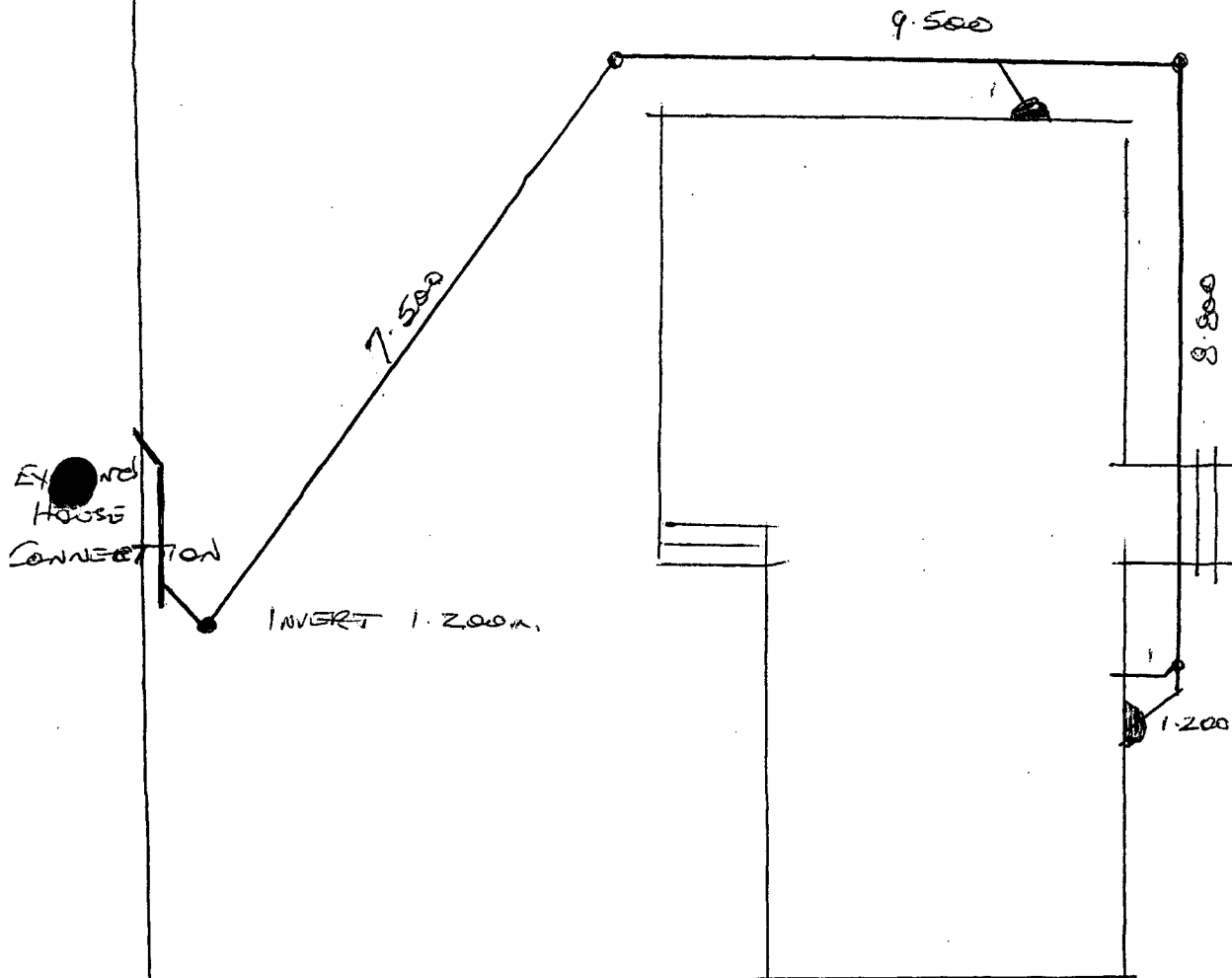

BERYL PL

(Loekwood Home Lnd)

OWNER G. BOYLE LOT 121 SEC 20544 BL. ~~175~~
No. 5 STREET S BERYL PL SIGNATURE [Signature] OF DRAINLAYER [Signature] DATE 25/3/81